

Recessed luminaire - Micro-prismatic diffuser - direct distribution

Sheet steel housing suitable for ceilings with visible T-rails, concealed symmetrical rail constructions and recessed ceilings; Housing colour traffic white RAL 9016; Direct light distribution using microprismatic pane made of PMMA, a soft light shines through frosted diffusers; neutral white light colour (840) with very good colour consistency and high colour rendering $R_a > 80$ for VDU workstations, $65^\circ < 3000 \text{ cd/m}^2$ with omnidirectional glare suppression according to current DIN-EN 12464-1 standard.; Integrated LED driver design.. Wired ready for connection via 9-pin connection terminal with plug-in contacts. Light Control: netlife easy01; Regiolux Classification: netlife easy; Control signal: DALI; Number of control gear (max): 32; Communication: Bluetooth; Sensor technology: PIR - passive infrared; Installation height (min/max): 2m to 5m; Monitoring area: max. $D=7\text{m}$; App name: Osram BT Config; Osram BT Control; Note: up to 4 DALI sensors or DALI push button coupler can also be connected; System extension: easy01S; Application: Office, Meeting rooms, Corridors, Classrooms, Secondary rooms; Function: Motion detection, Corridor function, presence detection, Daylight control, Tunable white (only with DT8 luminaires), Manual dimming. TNE-BM mounting mechanism 4 pcs. 600/625 for concealed symmetrical rail constructions or recessed ceilings, please order separately.

CHARACTERISTICS

Order number	50802118970
EAN number	4020863356775
Commodity code	94051190
Certification mark	IP 20, Protection class I, VDU $65^\circ < 3000$, F, F-"roof" mark, Indoor, CE
Impact resistance (IK rating)	IK02
Ambient temperatur	ta 25°C
Warranty period	5 years

ELECTRICAL ENGINEERING

Controller	Electronic driver DALI (1 pcs.)
Light Control	netlife easy01
System output	35W
Mains voltage	230V/50Hz
Circuit breakers (inrush current)	14 pieces/B10, 23 pieces/B16, 23 pieces/C10, 38 pieces/C16
Energy efficiency class/light source	C

LIGHTING TECHNOLOGY

Placement	LED, Colour rendering/Light colour CRI ≥ 80 / 4000K
Colour tolerance (MacAdam)	3SDCM
Photobiological safety (Luminaire)	RG0
Nominal luminous flux	4015lm
LED service life	50000h L80/B10 (Tq 25°C)
Luminaire luminous efficiency	116lm/W
UGR lat./long.	18.6 / 18.9

MECHANICS

Housing colour	traffic white RAL 9016
Dimensions (LxWxH/DxH)	622mm x 622mm x 102mm
Depth	100mm
Ceiling system	Ceilings with visible T-rails [s-TS] (625x625 mm), Concealed symmetrical rail construction [VS] (625x625 mm), cut-out ceilings [AD]
Ceiling cut-out (LxW/D)	585mm x 591mm
Installation depth	120mm [AD]; 250mm [s-TS]; 120mm [VS]
Weight (net)	5.5kg
Type of installation	Recessed mounting, Ceiling installation individual mounting

DEEP-LINK

<https://www.regiolux.de/en/article/50802118970>

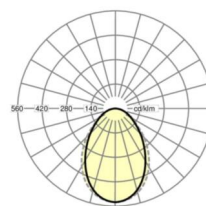

Reference	LED 4000lm 840
η_{LB}	100 %
$\Phi_{\downarrow/\uparrow}$	100 % / 0 %
UGR lat./long.	18.6 / 18.9
VDU	$65^\circ < 3000\text{cd/m}^2$

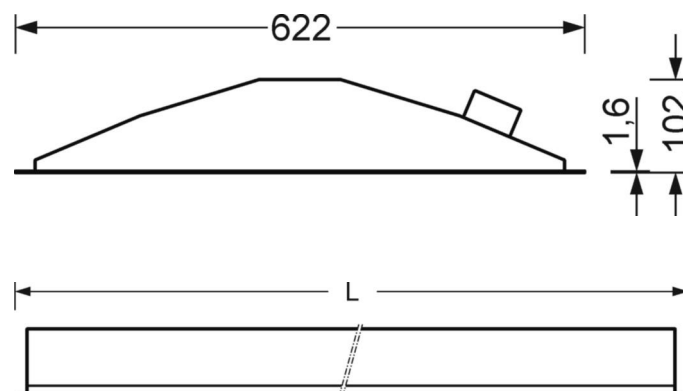

Dimensions

L	622 mm	Length
B	622 mm	Width
H	102 mm	Height
T	100 mm	Depth
DA(L)	585 mm	Cutting dimension length
DA(B)	591 mm	Cutting dimension width
Et(AD)	120 mm	Ceiling distance minimum (cut-out ceiling)
Et(TS)	250 mm	Ceiling distance minimum - recommended (visible T-rail)
Et(VS)	120 mm	Ceiling distance minimum (concealed symmetrical)
MLTS1	625 mm	Module dimension length (visible T-rail)
MLTS_1/2	625	Module dimension length (visible T-rail) 1/2
MLVS	625 mm	Module dimension length (concealed symmetrical)
MBTS1	625 mm	Module dimension width (visible T-rail)
MBTS_1/2	625	Module dimension width (visible T-rail) 1/2
MBVS	625 mm	Module dimension width (concealed symmetrical)

LC SYSTEM

CHARACTERISTICS

Regiolux Classification	netlife easy
Control signal	DALI
Number of control gear (max)	32
Communication	Bluetooth
Sensor technology	PIR - passive infrared
Installation height (min/max)	2m to 5m
App name	Osram BT Config; Osram BT Control
Note	up to 4 DALI sensors or DALI push button coupler can also be connected
System extension	easy01S
Application	Office, Meeting rooms, Corridors, Classrooms, Secondary rooms
Function	Motion detection, Corridor function, presence detection, Daylight control, Tunable white (only with DT8 luminaires), Manual dimming

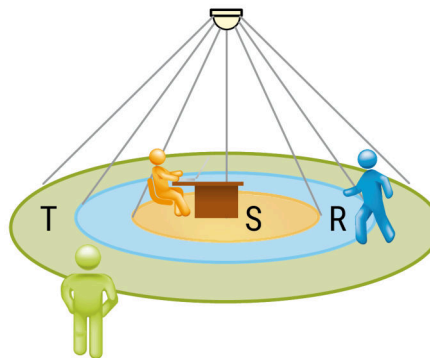

MONITORING AREA

Mounting Height	2,5m	3,5m	5m
Ø max. sitting[S]	3,3m	5m	-
Ø max. radial[R]	5,3m	7m	7m
Ø max. tangential[T]	-	-	-

